

INSTRUCTION MANUAL

NEW DELTA



株式会社アールエス
<http://www.rs2006.co.jp>

TEL. 福岡本社 092-622-1337 世田谷 03-3300-8833 東京 0426-42-5890
大阪 06-6399-9006 佐賀 0952-26-3678 沖縄 098-944-1603

CONTENTS

1. HANDLING ATTENTION.....	Page 2
2. COMPOSITION	Page 4
3. ATTACHED PART.....	Page 5
4. SERVICE DOOR	Page 6
5. MAINTENANCE DOOR	Page 7
6. CONTROL PANEL BOX	Page 8
7. MONITOR ADJUSTMENT.....	Page 9
8. GAME BOARD CHANGE.....	Page 10
9. CONTROL PANEL	Page 11
10. MONITOR POSITION	Page 12~14
11. MONITOR CHANGE... ..	Page 15
12. PARTS LIST.....	Page 16~Page 34
13. DIAGRAM	Page 35

1. HANDLING ATTENTION

Please pay enough attention when set up or inspect this machine as follows. .
Any mishandling might cause accident or trouble of this machine.



警告

- Please handle it after shutting off power. If not, it might cause electric shock or trouble of machine.
- Do not take off plug hastily. It might cause electric shock or trouble.
- Do not touch plug while hand is wet. It might cause electric shock or trouble.
- Do not expose power cord or ground wire on pathway.
- Do not put anything above power cord or damage it. It might cause fire or electric shock.
- Do not pull power cord strongly when set up. Any damage to it might cause fire or electric shock.
- Ground wire must be set. If not, it might cause electric shock.
- Use specified fuse. If using others, it might cause fire or electric shock.
- Power is from AC95~AC110V. The best condition is to use AC100V.
- Do not revise this machine, it might cause unexpected trouble.
- In case of any emergency, please shut down power, stop operation and pull the power code from plug. Otherwise it might cause fire or other accidents.

Warranty

This machine has 3 months' warranty after selling. We will repair it in case of trouble caused initially by us. When in trouble, please pull power code from plug and contact our office as soon as possible.

The other trouble caused by nature, inevitable accidents will be out of warranty.

RS Co., Ltd.

TEL 092-622-1337 FAX 092-622-1348



警告

- This machine is used indoors. Please do not set it outdoors.
- Indoors, please do not set in the following places.
 - Place where rain or water leaks, near to pool, shower.
 - Place where gets sunshine directly, or near to stove, heater.
 - Place with flammable gas, volatile drugs or other dangerous stuff.
 - Place wherever has much dust.
 - Place with strong vibration.
 - Exit, near to fire extinguisher, and other emergency supplies.
 - Place which is under 5°C or over 30°C.
- Please use single power with circuit breaker. Without the breaker, it might Cause fire when circuit short
- Do not use multi-wiring. Too much burden might cause heat and fire.
- Make enough space more than W0.9mD1.6m.
- Make sure door must be over W0.9mH1.6m.



警告

- Please confirm adjusters reach to floor. If it is not firmly reached to floor, The cabinet might move during play.
- Do not place any heavy things on this machine. It might cause accident or Damage to machine parts.
- Do not climb to the machine.
- Confirm that door, cover parts are not damaged.
- Do not put vessel with water, drug above or around the machine.
- Do not let the following personnel play on this game. It might cause unexpected accident or injury.
 - Person who must need help at walking, with high pressure, heart disease
 - Who has lost consciousness during playing TV game.
 - Person who has disease at neck, spinal and who is pregnant.
 - Person who is easily drunk and who is drunken.
 - Please stop behavior such as kicking or hitting this machine.

2. COMPOSITION



NEW DELTA SPEC

Cabinet	SIZE	W: 820 D: 820 H: 1530
	WEIGHT	135kg
	POWER CONSUMPTION	220W
Monitor	SIZE	32inch TFT LCD
	RESOLUTION	15K~1360×768 auto change
With I/O・Power Supply = 5V 12V 3.3V 0V		
One touch change of Screen to Vertical or Horizontal		
PCB Interface for New JAMMA & Old JAMMA		

3. ATTACHED PARTS

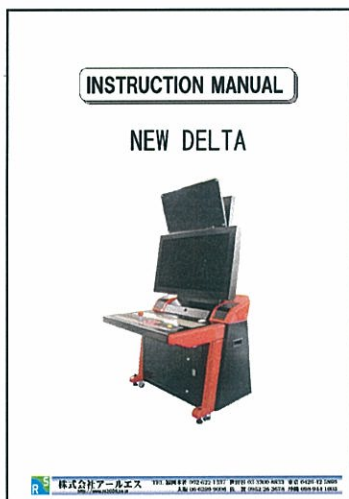

MANUAL



Control panel key



Key 001 (service key) × 1pc



50 YEN ENTRY PLATE



Key 002 (cash box key) × 1pc



Entry seal 50 Yen

Entry Seal 100 Yen

Entry Seal 100 円 2PLAY

Entry seal MEDAL

4. SERVICE DOOR

Power Supply Voltage Adjustable each

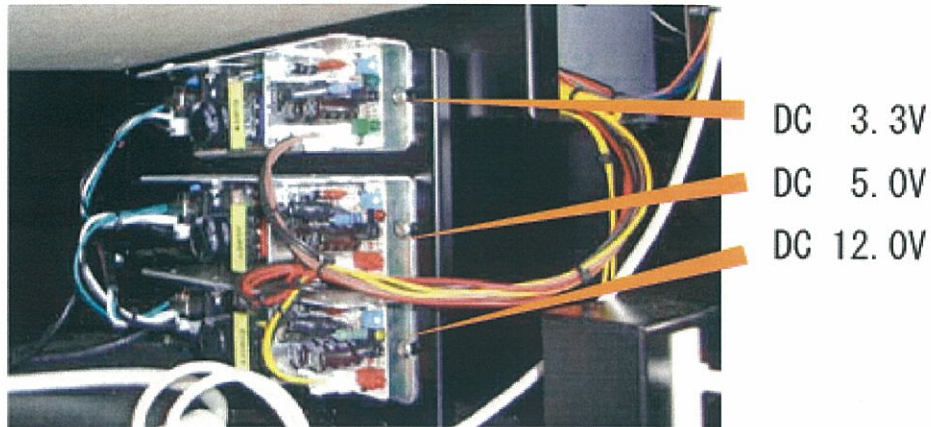

- 3.3V LED : Green Led Lamp. Turn on when power in.
- 5V LED : Red Led Lamp. Turn on when power in
- 12V LED : Orange Led Lamp. Turn on when power in
- 3.3V Voltage adjust: Volumn to adjust 3.3V voltage
- 5V Voltage Adjust:Volumn to adjust 5V voltage.
- 12V Voltage adjust: Volumn to adjust 12V Voltage

ATTENTION: Ajustment finished, please do not touch.

5. Maintenance door



- SERVICE 1 : Service Credit switch.
- SERVICE 2 : Service credit switch for 2P.
- V/R : Sound volume adjust.
- T/R : Sound tone adjust.
- METER1 : Coin meter
- METER2 : Do not use
- POWER S/W : Main power switch.

6. Control panel box

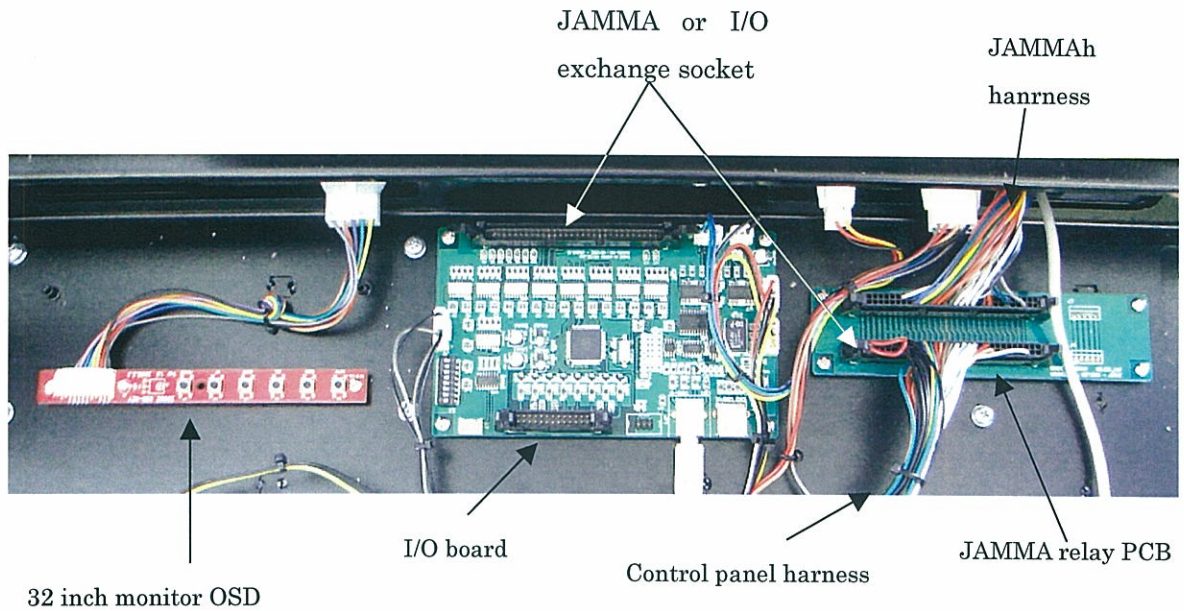

- I/O board
Board to control in-out signal except picture, sound (test, service, coin Switch, meter, control panel)
- Control panel harness
Harness from control panel button and joystick. According to game PCB, Insert socket to I/O board or JAMMA relay PCB.
- 3 2 inch monitor OSD

OLD JAMMA/ NEW JAMMA CONNECTION SAMPLE

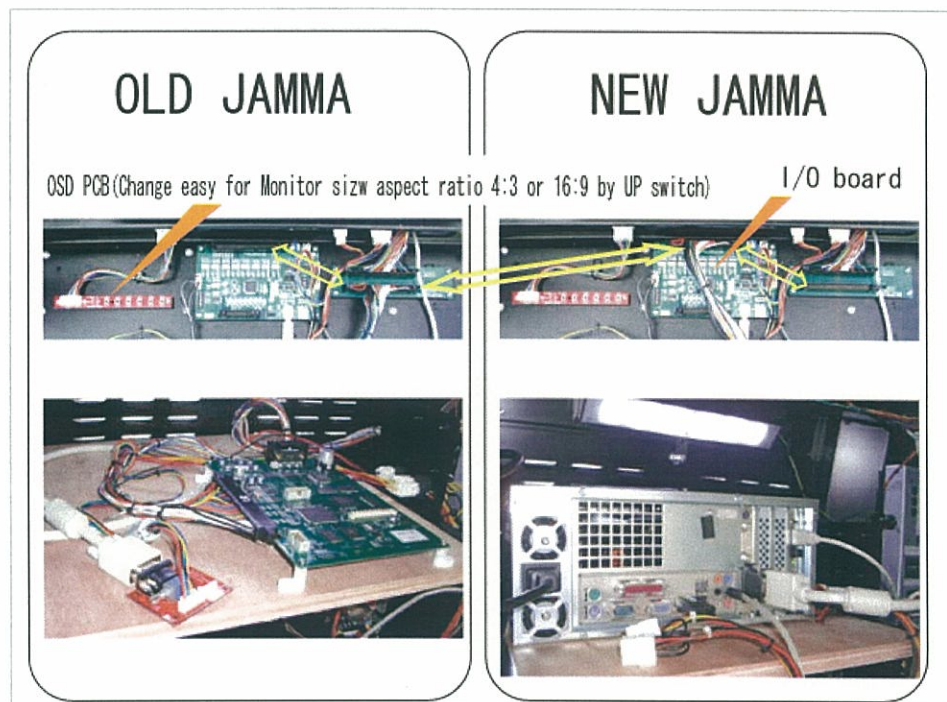

7. Monitor adjustment

Adjust monitor by OSD board inside control panel base box. Here is a sample of 32inch monitor.

32インチモニターOSD



AUTO MENU SEL DOWN UP POWER LED LAMP

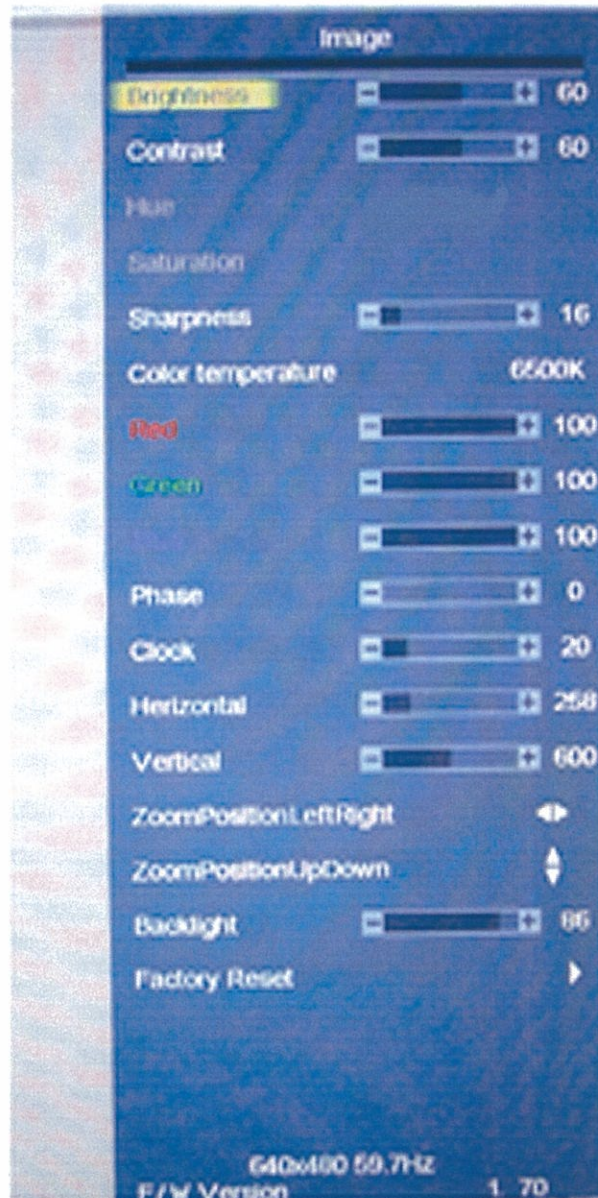

- Use AUTO、MENU、SEL、DOWN、UP、to adjust.
-
- Push AUTO to adjust picture automatically.
-
- Push Menu, OSD menu will show Up. Push SEL to choose item.
-
- Horizontal level change.
-
- Vertical level change
-
- ZoomPositionLeftRight
-
- ZoomPositionUpDown
- MENU+UP to change to Auto color.
- Push Power button to turn on or Off inside monitor.
- LED LAMP
Turn green when normal.
Turn red when no picture signal In.
Turn orange when no power in Monitor.

8. Game board change

Service door inside

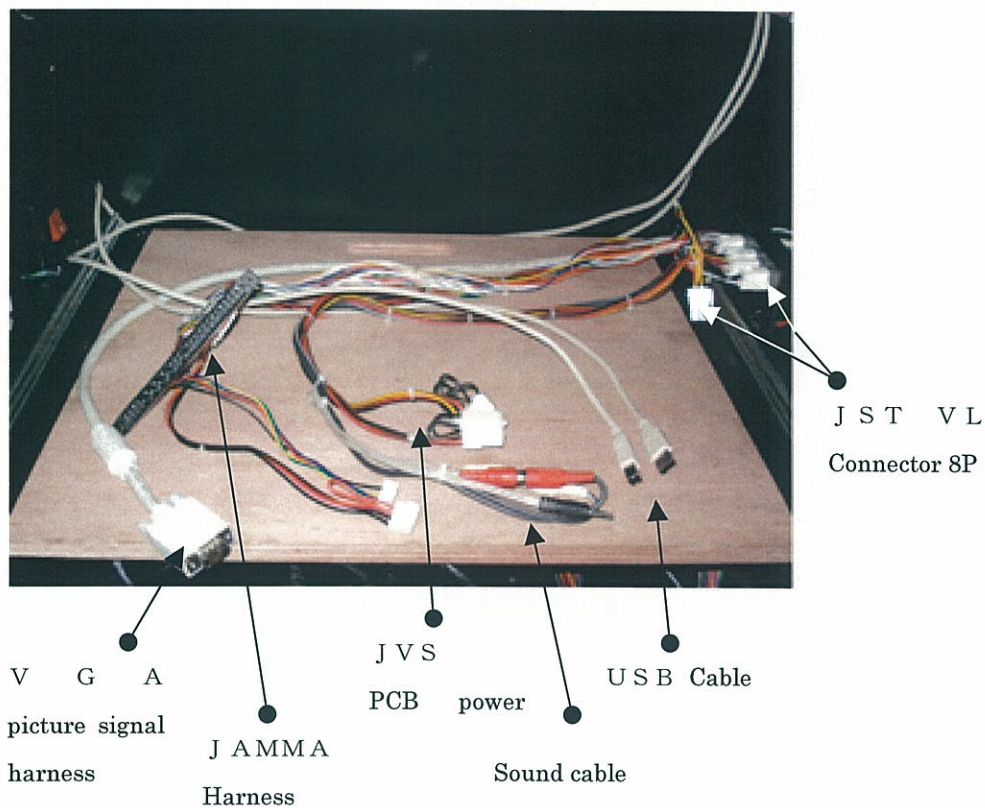

- Turn off power when open maintenance door to operate.
- Do not damage harness, it might cause trouble or accident.

This machine can play both JAMMA and JAMMA VIDEO boards.

Use JAMMA harness or JVS board power harness according to each game.

In case of using JST VL connector 8P (male), please note connector No. 4 and No.8 are connector with brown harness.

9. Control panel change



- Turn off power when operate on it.
- Do not damage harness, it might cause trouble, electronic shock etc.



- Pay attention not to hurt fingers when open or close panel.
- Panel base could fall down due to its weight, be careful to lift it up Safely.



Open control pane with key, pull it to front and turn key with clockwise.

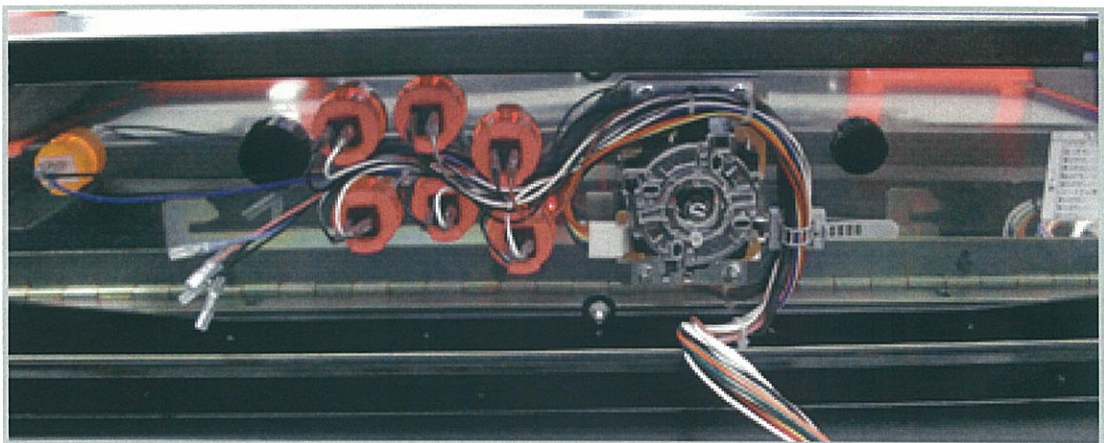

Control panel was fixed by 6 nuts. Please remove nuts first .

10. Monitor position change to Horizontal or vertical

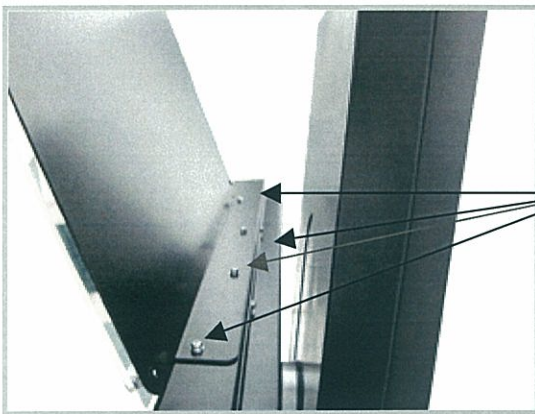

Take off billboard first.
Remove screws at 4 positions.

Screws and nuts

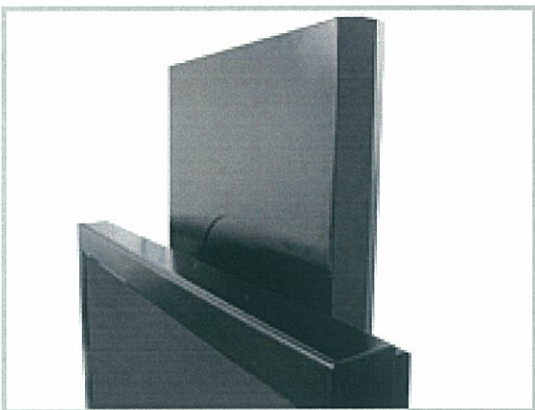

Billboard was taken off.

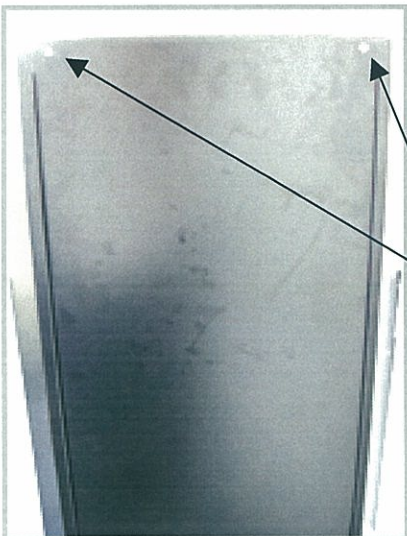

Remove 2 screws and open back.

SCREWS



Pull lever and handle to slide to top.



When it was slid to top.

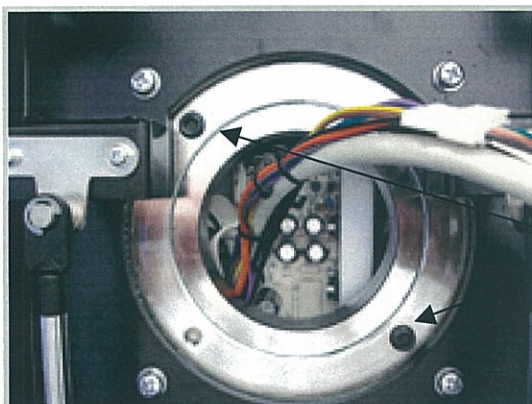

Loose these screws

screws

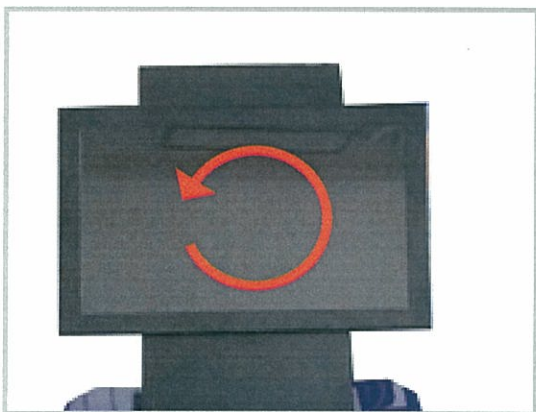

Turn monitor clockwise

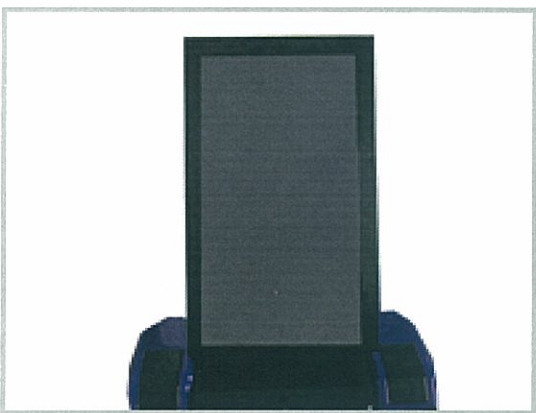

Then fix it again with screws.

11. How to change monitor



警告

- Turn off all power before removing plug or connectors in order to prevent electric shock or circuit.
- Person except technician with enough knowledge can not operate.
- Operate in a enough space for your safety.
- Do not damage harness, any damage will cause trouble or electric Shock or circuit.



注意

- At least 2 persons are necessary when changing monitor.
- Monitor is heavy, be careful not to let it fall down to get hurt.

Take off monitor back cover.

Remove 4 of screws which attached to the monitor cover.



Turn monitor to horizontal, remove 4 screws left.

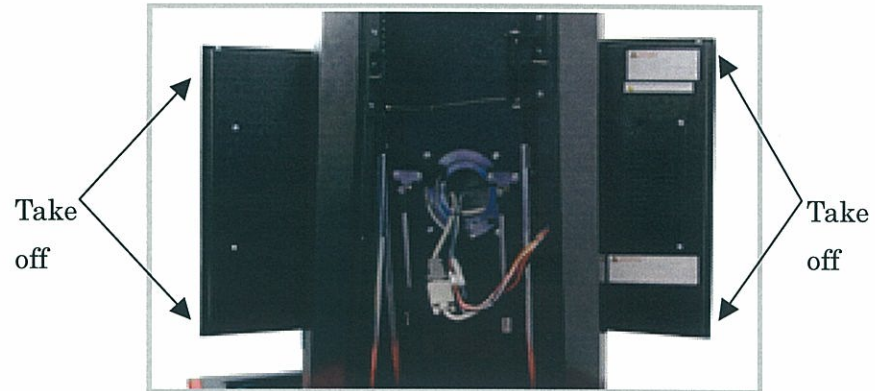

Pull monitor cover to front and take it off.



Go to backward to remove connectors attached to monitor.

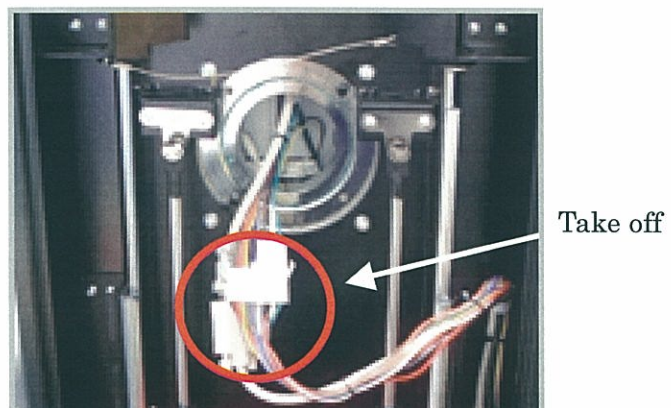

Remove 5 screws attached to monitor

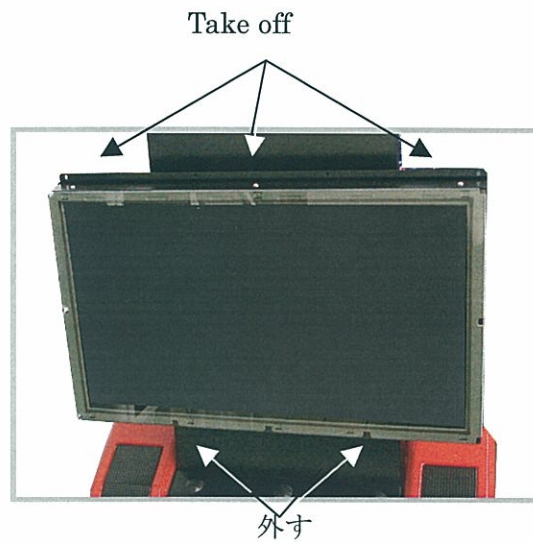

Pull monitor together with front glass
Do not damage harness, PCB etc.

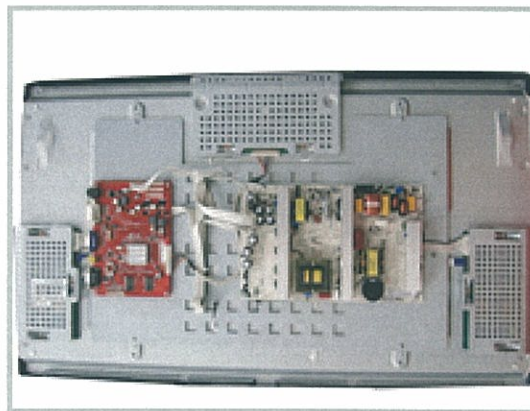

Put on monitor following the above steps.

12. PARTS LIST

1. Assembly

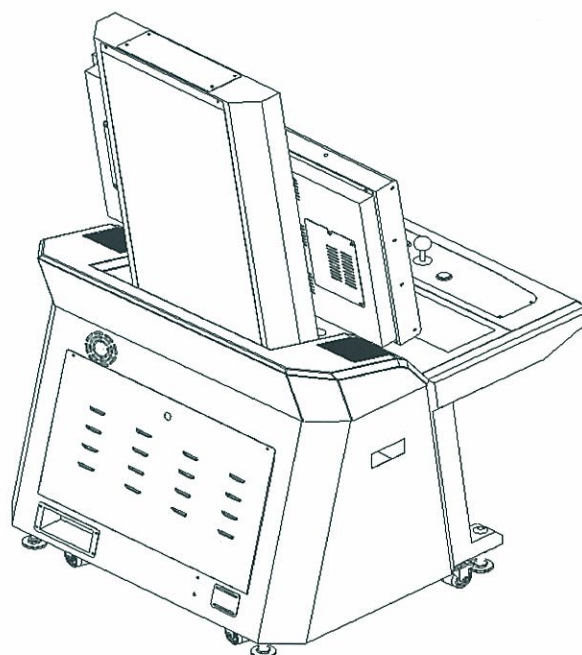
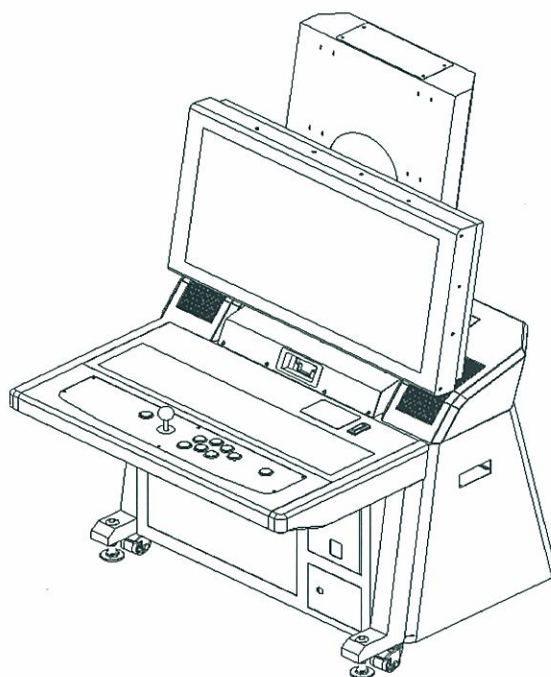

2. Whole of Assembly Drawing

No.	Parts list	note	QTY
1	32 Inch assembly		1
2	Body assembly		1
3	Button board assembly		1
4	Plastict assembly		1
5	Rotary board assembly		1
6	Piller assembly		1

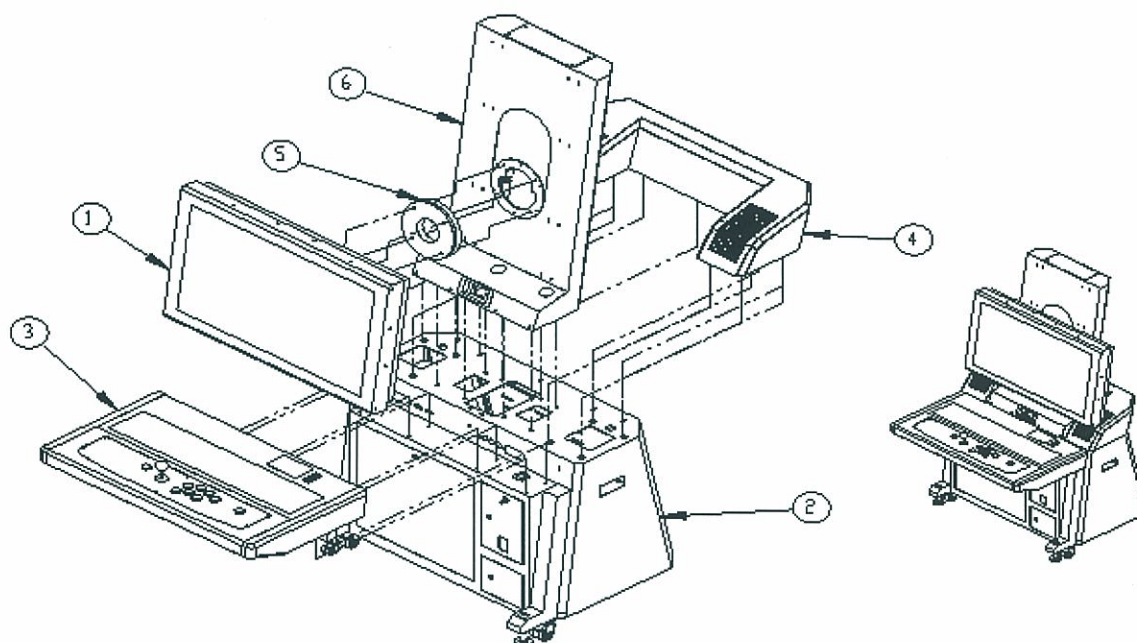

3-1. Body

No.	Parts list	note	QTY
1	Noise Fiter Cover		1
4	Body		1
24	Back door		1
42	Service Hole Cover		1
43	B18.6.7M – M4 x 0.7 x 10 Type I Cross Recessed PHMS -- 10N		52

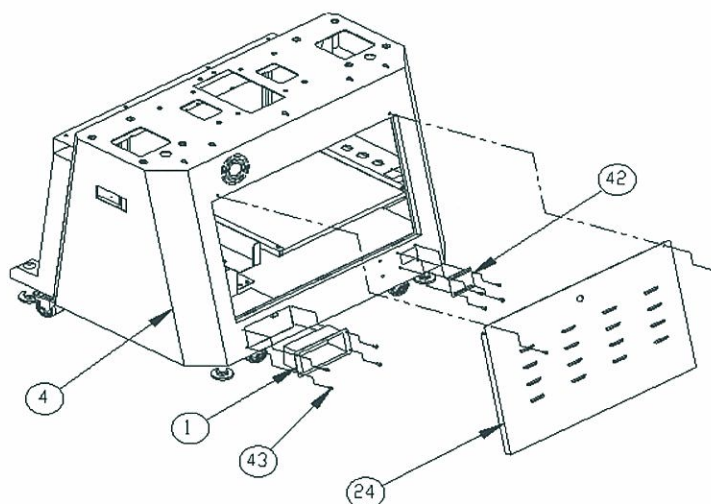

3-2. Body

No.	Parts list	note	QTY
7	Bottom board		1
16	Rightlathe		1
17	Right housing angle		1
21	Left lathe		1
22	Left lathe and lowercover		1
23	Block board		1
31	Top coin line		1
32	Front Body1		1
38	Bottom coin line		1
43	B18.6.7M - M4 x 0.7 x 10 Type I Cross Recessed PHMS -- 10N		52
47	B18.6.7M - M4 x 0.7 x 25 Indented HHMS --25N		4

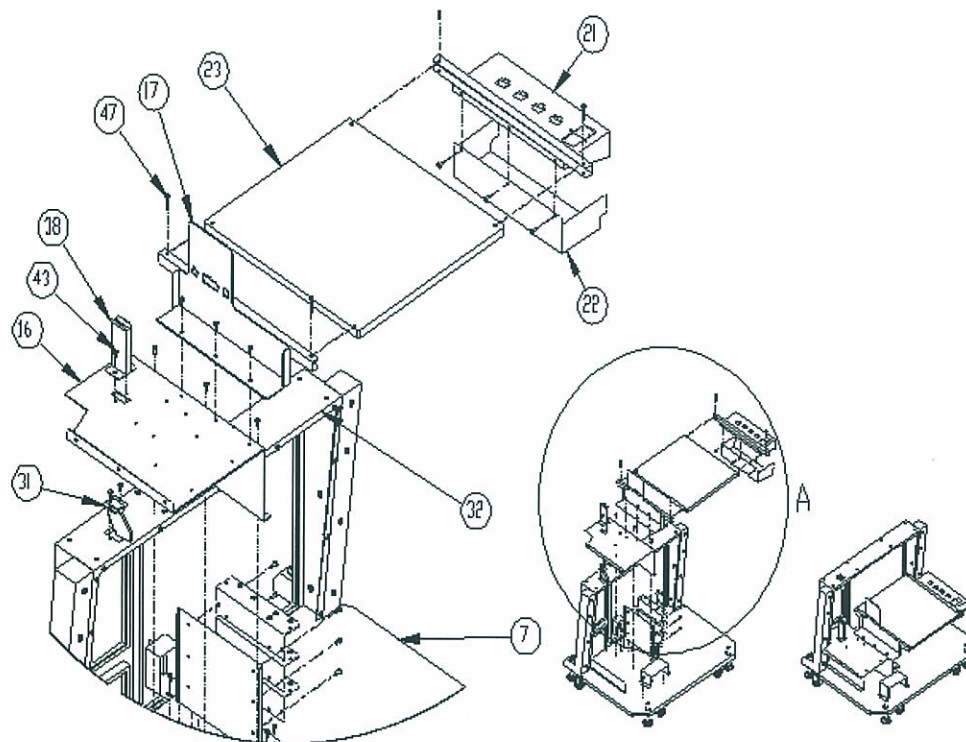

3-3. Body

no.	Parts list	note	QTY
2	Noise filter and Back cover		1
7	Bottom board		1
8	Board angle		1
9	Board radiation board		3
13	Switch		1
14	Switch box		1
43	B18.6.7M - M4 x 0.7 x 10 Type I Cross Recessed PHMS -- 10N		52

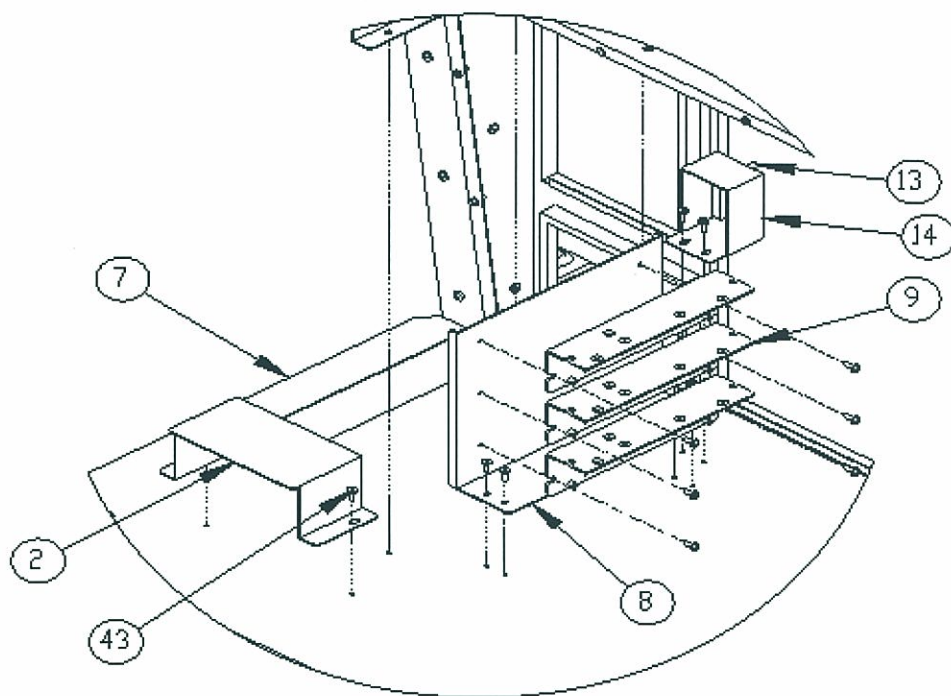
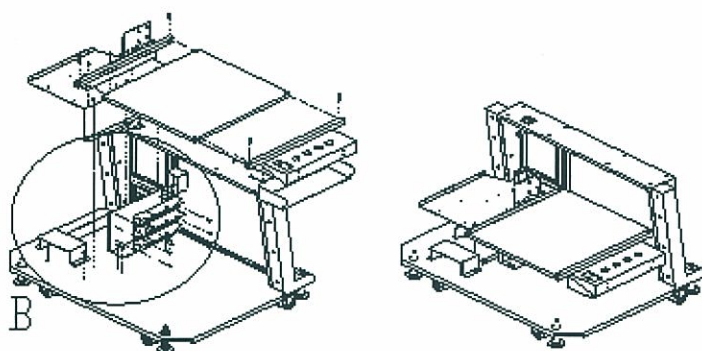

3-4. Body

No.	Parts list	note	QTY
4	Body		1
25	Coin exit		1
27	Coin box		1
28	Coin box partition		1
29	Door		1
33	Front body coin merchine door		1
35	Coin merchine bracket		1
36	Coin merchine bracket2		1
37	Coin merchin bracket3		1
39	Bottom coin line		1
43	B18.6.7M - M4 x 0.7 x 10 Type I Cross Recessed PHMS -- 10N		58
48	B18.2.4.1M - Hex nut, Style 1, M4 x 0.7 --D-C		19

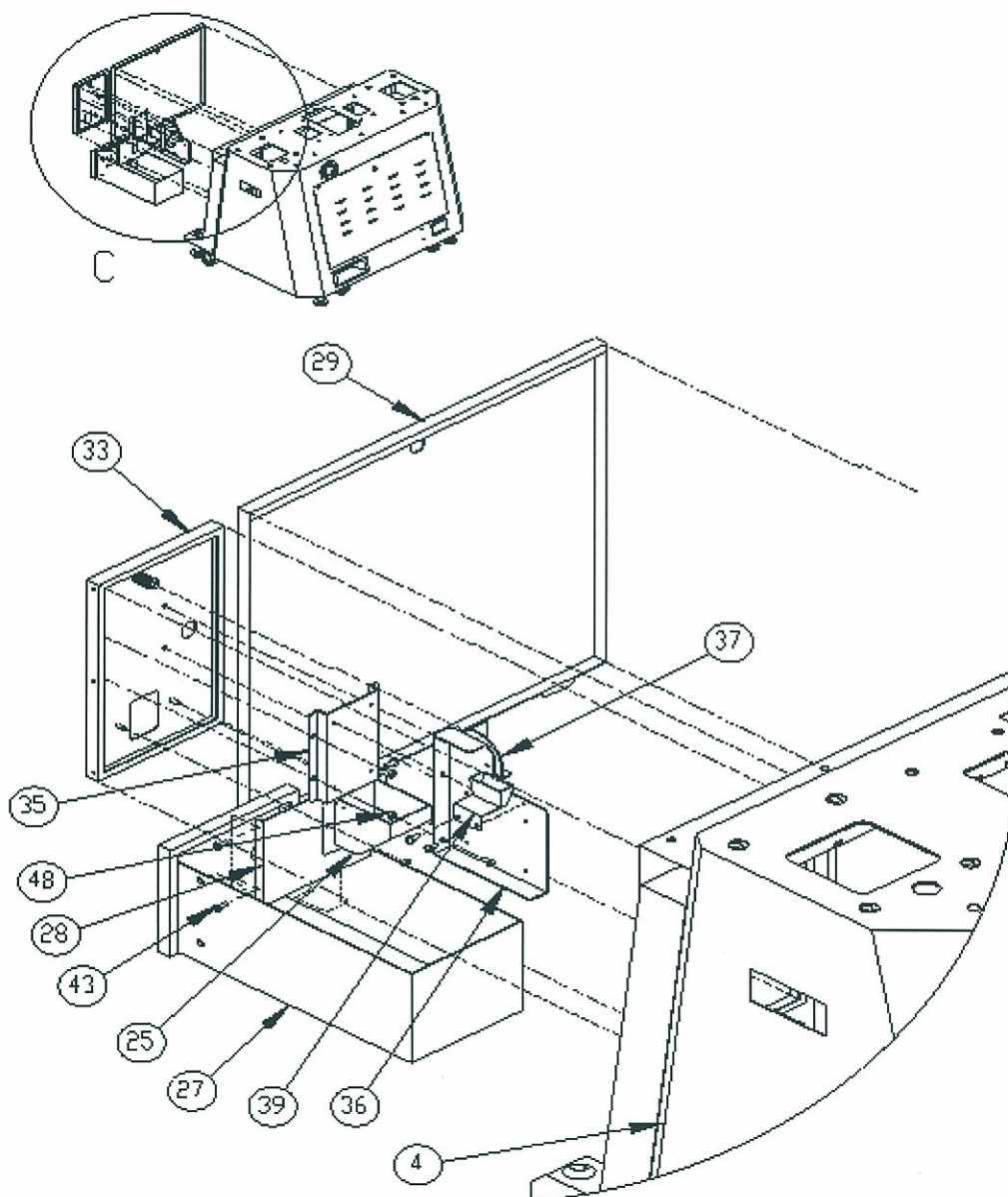

3-5. Body

No.	Parts list	note	QTY
4	body		1
34	Regulator valve		4
40	Caster		2
41	Caster-1		2
44	B18.6.7M - M6 x 1.0 x 10 Type I Cross Recessed PHMS --- 10N		8

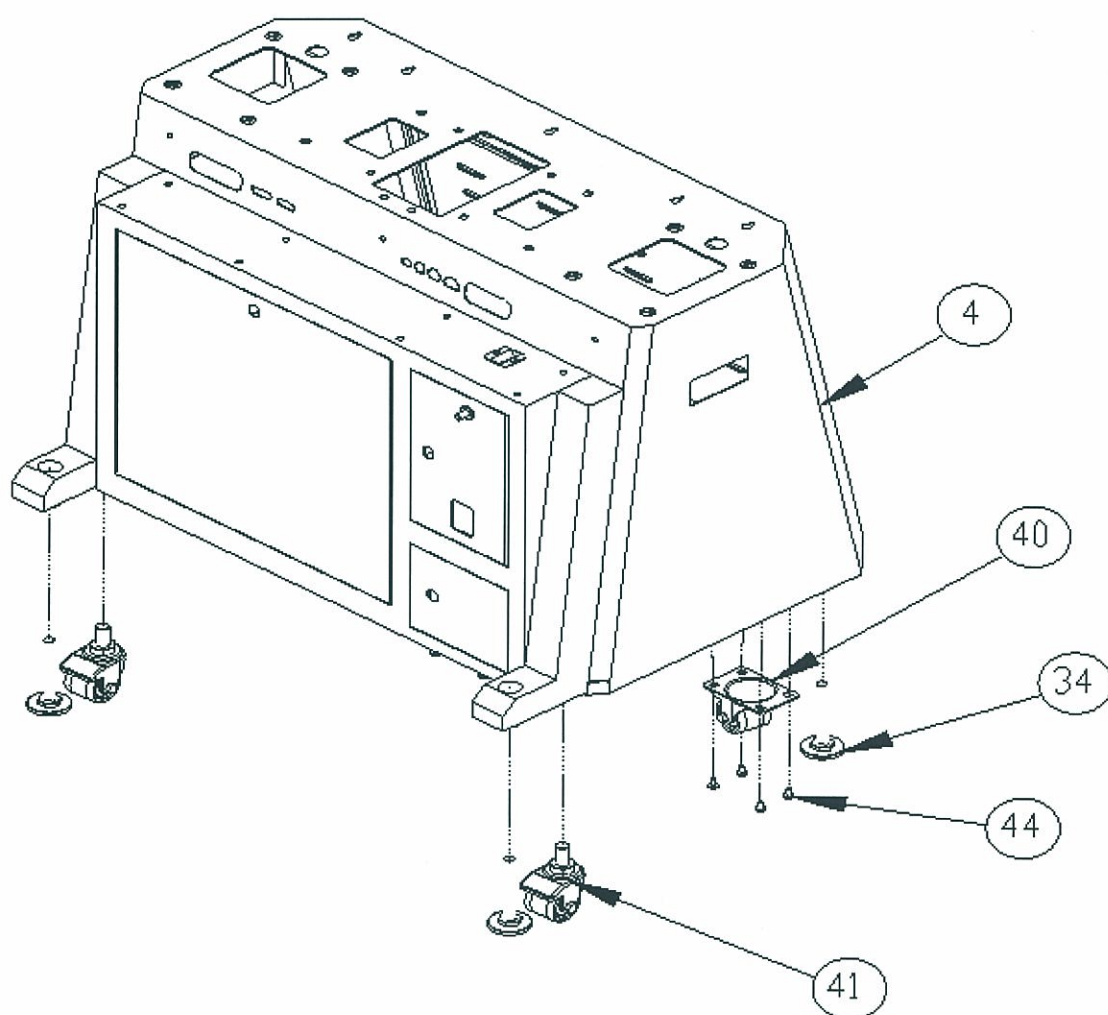

4-1. Pillar

No.	Parts list	note	QTY
1	Pillar BODY		1
2	Rail guide		2
3	Reinforcement		1
4	Ball bearing guide		2
5	Upper lid		1
6	Show bar or bracket		1
10	Front cover		1
11	Card		1
12	Card recognize entry		1
13	Radiation board fixing stand		1
14	Rubber		3
15	Ball bearing		2
16	Rail assembly		2
17	B18.6.7M - M4 x 0.7 x 10 Type I Cross Recessed PHMS -- 10N		34
18	B18.6.7M - M5 x 0.8 x 13 Type I Cross Recessed PHMS -- 13N		4
19	B18.6.7M - M4 x 0.7 x 13 Type I Cross Recessed PHMS -- 13N		16
20	Lock		1
21	Lock-1		1
22	Lock equipment-1		2
23	Lathe		4
24	Show bar		2
25	Back cover		1
26	B18.2.4.1M - Hex nut, Style 1, M3 x 0.5 --D-C		4

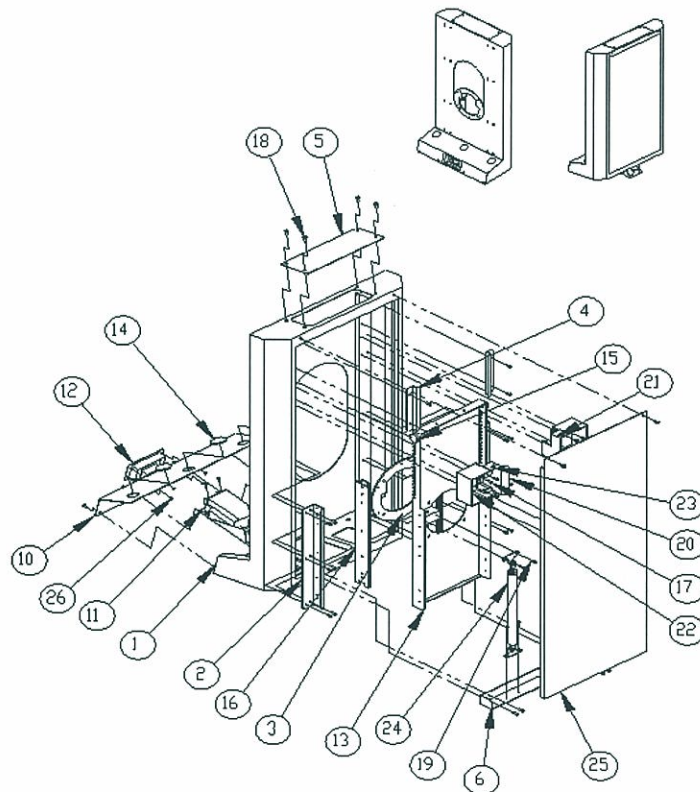

4-2. Piller

No.	Parts list	note	QTY
1	Piller BODY		1
10	Front cover		1
11	Card merchine		1
12	Card recognize entry		1
14	Rubber		3
17	B18.6.7M - M4 x 0.7 x 10 Type I Cross Recessed PHMS -- 10N		34
19	B18.6.7M - M4 x 0.7 x 13 Type I Cross Recessed PHMS -- 13N		16
26	B18.2.4.1M - Hex nut, Style 1, M3 x 0.5 --D-C		4

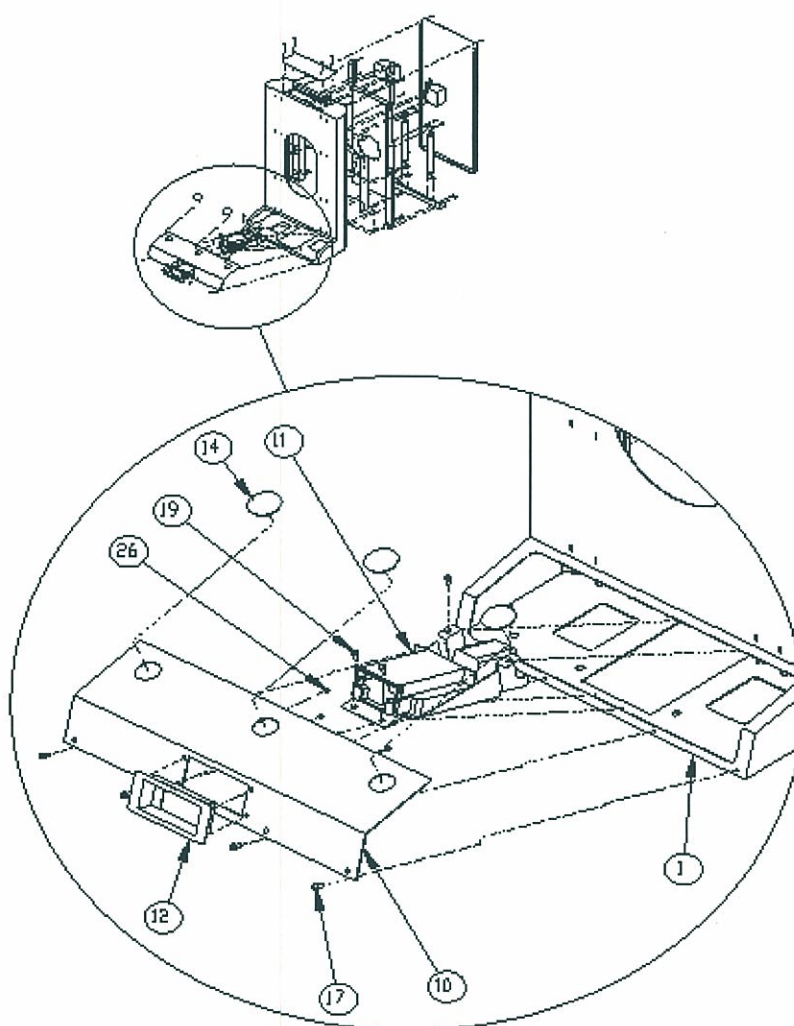

4-3. Piller

No.	parts list	note	QTY
1	Piller BODY		1
2	Rail guide		2
4	Ball bearing		2
5	Upper lid		1
6	Show bar or bracket		1
17	B18.6.7M - M4 x 0.7 x 10 Type I Cross Recessed PHMS -- 10N		34
18	B18.6.7M - M5 x 0.8 x 13 Type I Cross Recessed PHMS -- 13N		4
19	B18.6.7M - M4 x 0.7 x 13 Type I Cross Recessed PHMS -- 13N		16
20	Lock		1
21	Lock-1		1
22	Lock-2		2
23	Lathe		4
25	Back cover		1

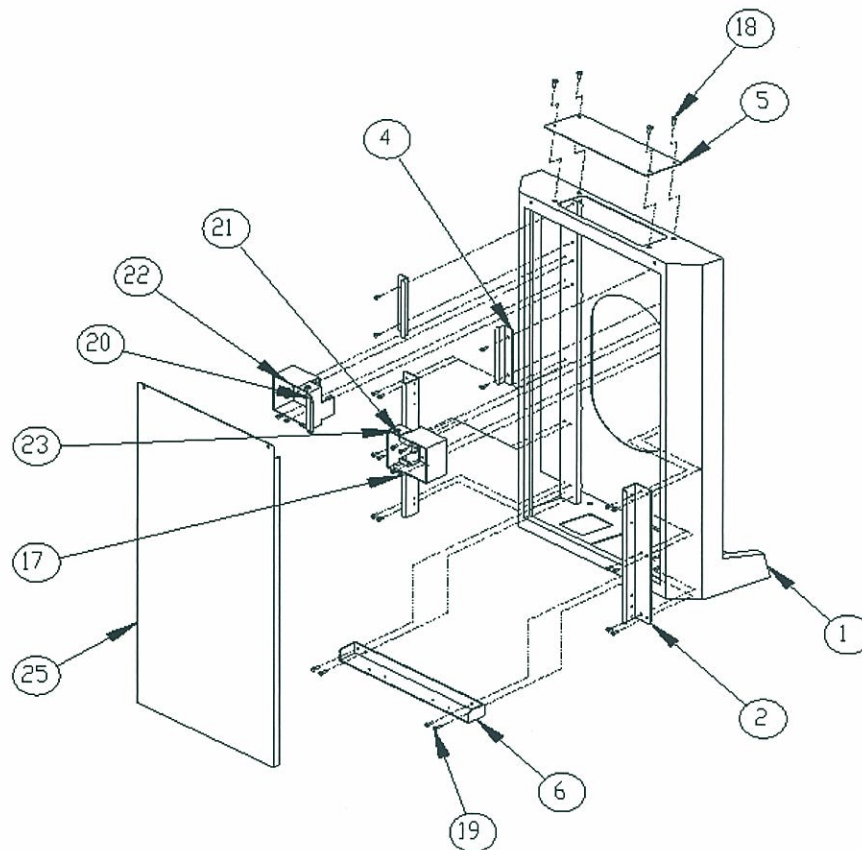

4-4. Piller

No	Parts list	note	QTY
1	PillerBODY		1
2	Rail guide		2
3	Reinforcement		1
6	Show bar or bracket		1
13	Rotation board fixing stand		1
15	Ball bearing		2
16	Rail assembly		2
17	B18.6.7M - M4 x 0.7 x 10 Type I Cross Recessed PHMS -- 10N		34
19	B18.6.7M - M4 x 0.7 x 13 Type I Cross Recessed PHMS -- 13N		16
20	Lock		1
21	Lock-1		1
22	Lock equipment-1		2
23	Lathe		4
24	Show bar assembly		2

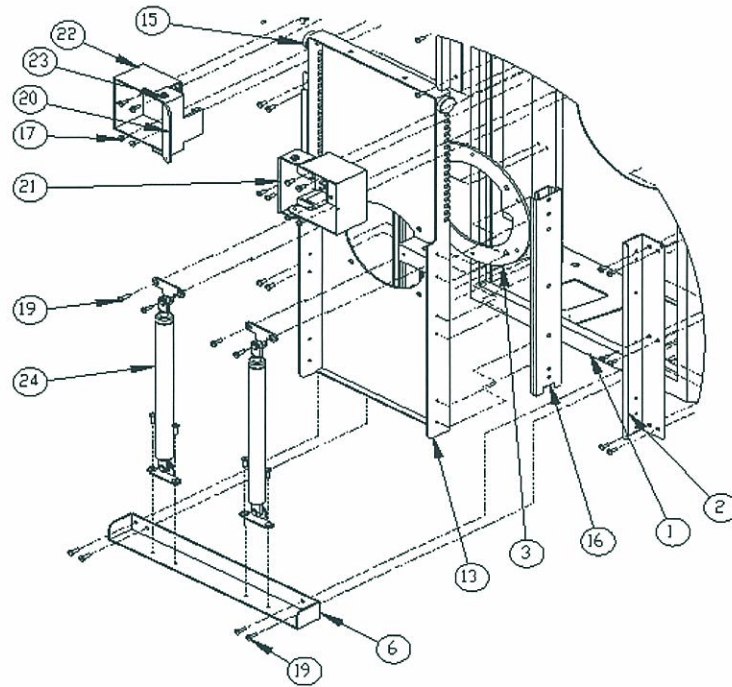
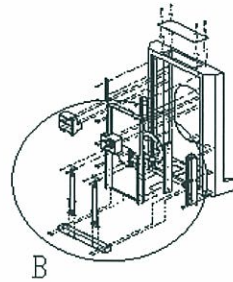

5. 32" LCD panel

No.	Parts list	note	QTY
1	Mask		1
2	Mask accessories		1
3	Mask accessories2		1
4	Mask accessories3		2
5	Board		1
6	Board-1		1
7	Open frame		1
8	Open frame1		1
9	Frame-right bracket		1
10	Frame-left bracket		1
11	LCD radiation board		1
12	Tempread glass-1		1
13	32Inch panel		1
14	B18.2.4.1M - Hex nut, Style 1, M4 x 0.7 --D-N		8
15	B18.6.7M - M4 x 0.7 x 10 Type I Cross Recessed PHMS --10N		22
16	B18.6.7M - M3 x 0.5 x 10 Type I Cross Recessed PHMS --10N		8
17	B18.6.7M - M6 x 1.0 x 13 Type I Cross Recessed PHMS --13N		4

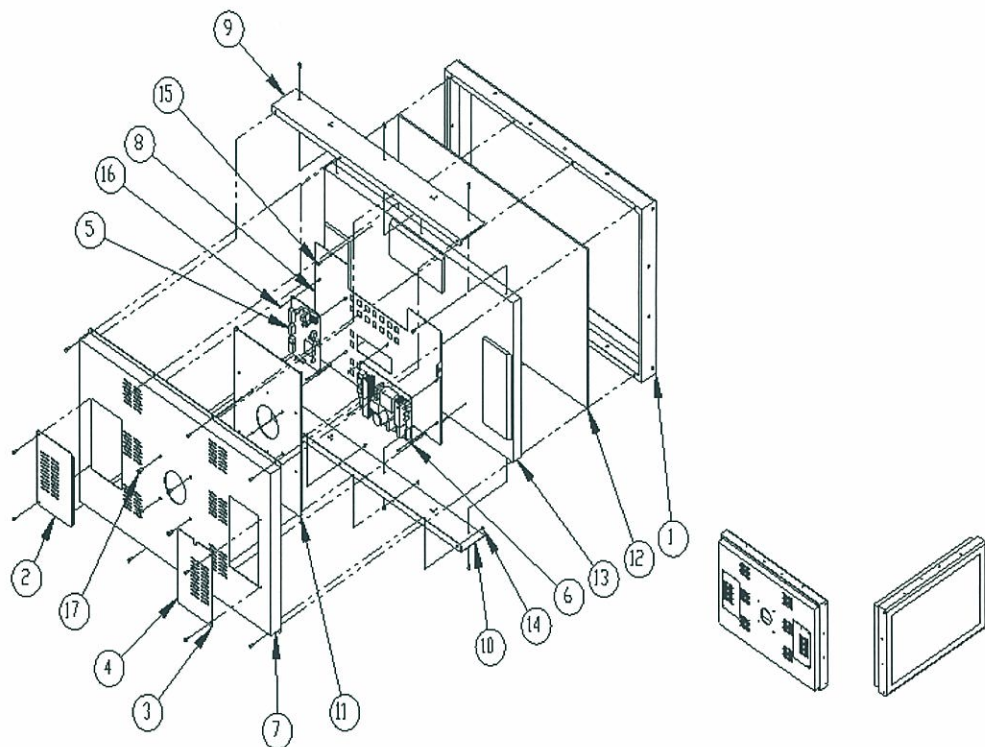

6-1. Burton board

No.	Parts list	note	QTY
4	Menu board Acrile		1
5	Menu board glass		1
7	Bottome Burton board		1
13	Right emission		1
15	Left emission		1
18	Coin board		1
19	Housing bracket-1		1
20	Housing bracket-2		1
21	key bar		1
23	LED board		1
27	B18.6.7M - M4 x 0.7 x 10 Type I Cross Recessed PHMS -- 10N		12
28	B18.2.4.1M - Hex nut, Style 1, M6 x 1 --D-C		4
30	B18.2.4.1M - Hex nut, Style 1, M4 x 0.7 --D-C		12

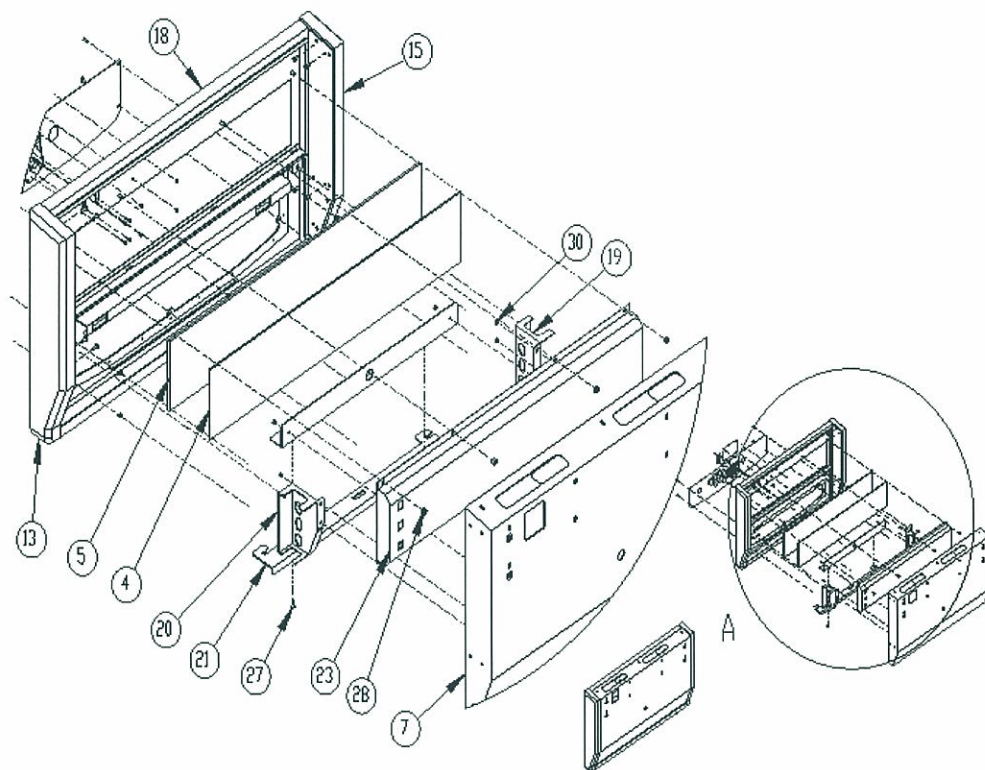

6-2. Burton board

No	Parts list	note	QTY
7	Bottom burton board		1
12	Lock bracket		1
19	Housing bracket-1		1
20	Housing bracket-2		1
21	key bar		1
23	LED board		1
27	B18.6.7M - M4 x 0.7 x 10 Type I Cross Recessed PHMS -- 10N		12
28	B18.2.4.1M - Hex nut, Style 1, M6 x 1 --D-C		4
30	B18.2.4.1M - Hex nut, Style 1, M4 x 0.7 --D-C		12

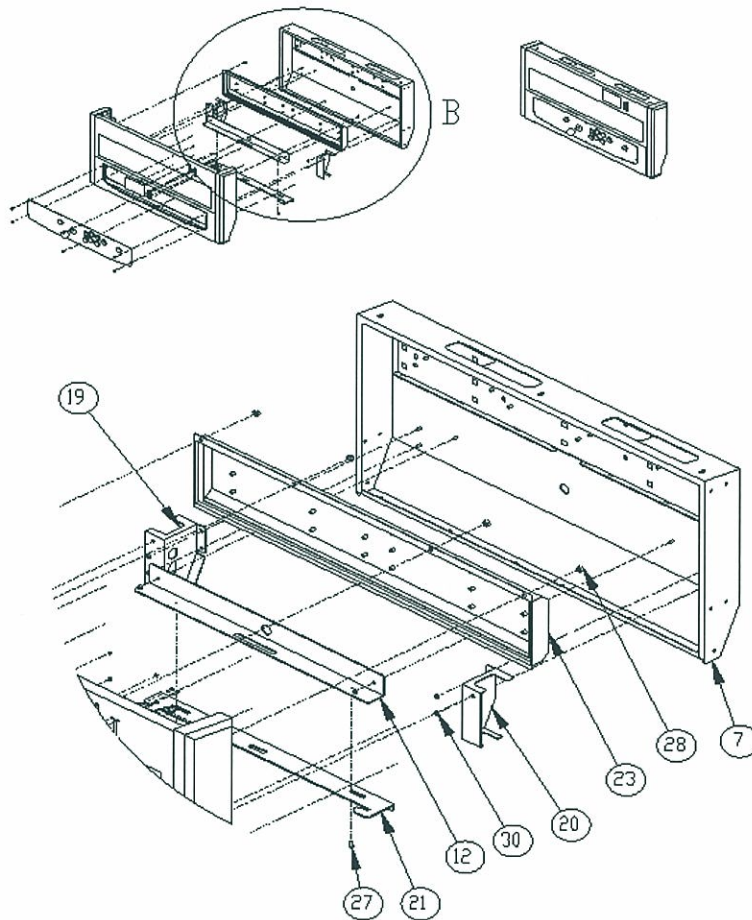

6-3. Button board

No.	Part list	note	QTY
7	Bottom burton board		1
14	Manufacturing board		1
16	Coin lid		1
17	Coin entry		1
18	Coin board		1
26	B18.6.7M - M3 x 0.5 x 10 Type I Cross Recessed PHMS -- 10N		4
29	B18.2.4.1M - Hex nut, Style 1, M3 x 0.5 --D-C		4
30	B18.2.4.1M - Hex nut, Style 1, M4 x 0.7 --D-C		12
31	Iron leg screw		6

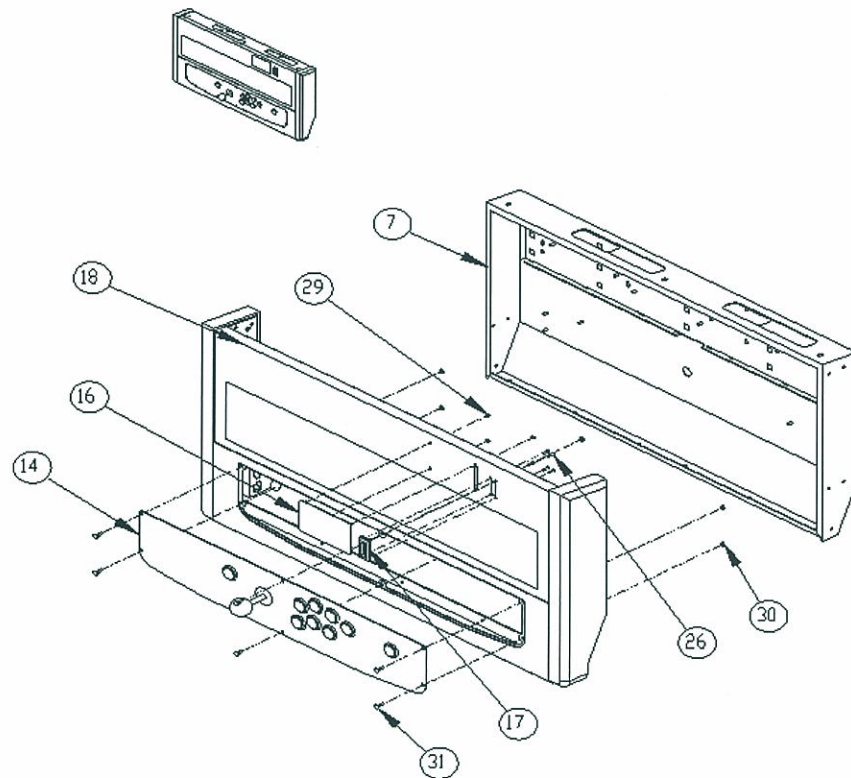

7-1. Plastic product

No.	Parts list	note	QTY
1	Plastic product		1
2	Speak		2
3	Speaker cover		2
4	Speaker case		2
5	Right reinforcement		1
6	Left reinforcement		1
7	Middle reinforcement		1
8	B18.6.7M – M4 x 0.7 x 10 Type I Cross Recessed PHMS -- 10N		28
9	B18.6.7M – M3 x 0.5 x 10 Type I Cross Recessed PHMS -- 10N		16

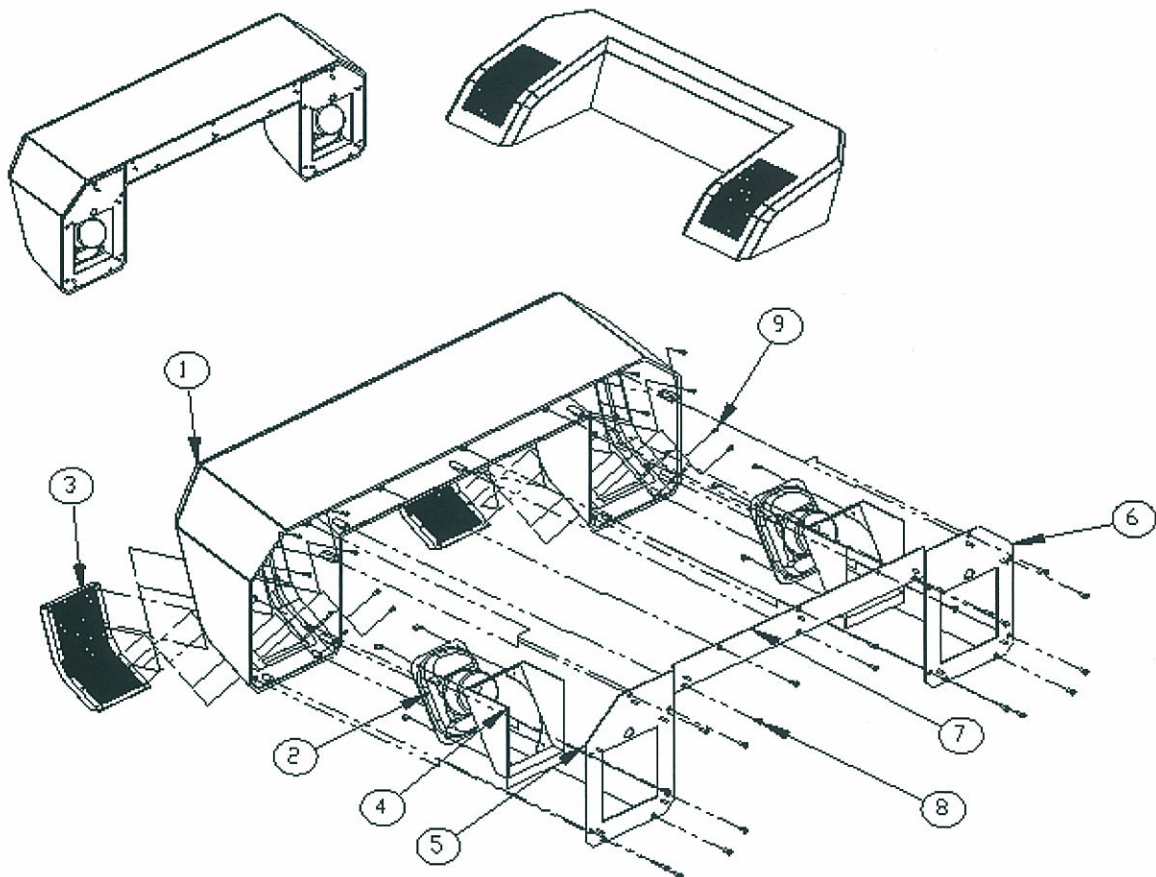

7-2. Plastic product

No.	Parts list	note	QTY
1	Plastic product		1
3	Speak cover		2
9	B18.6.7M - M3 x 0.5 x 10 Type I Cross Recessed PHMS -- 10N		16

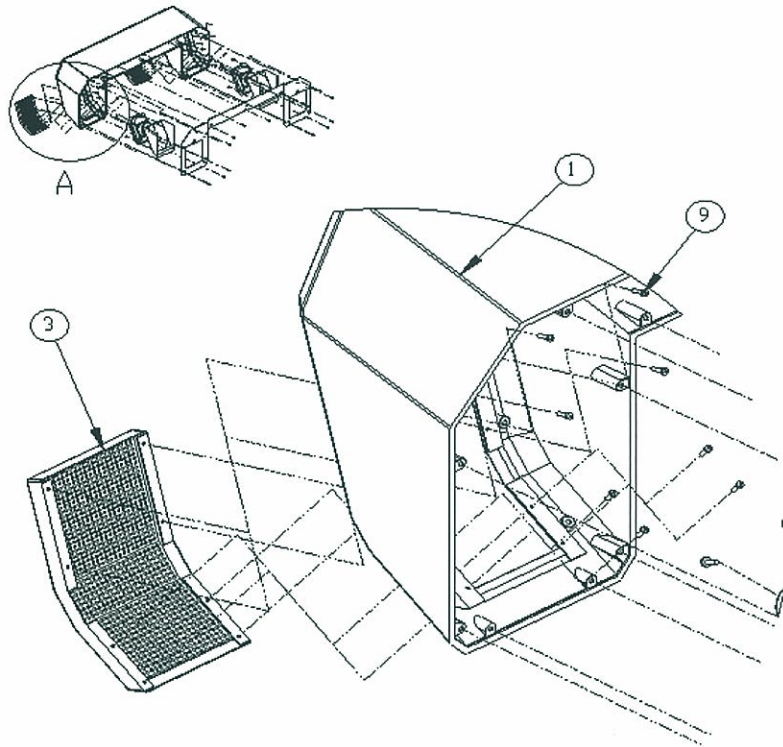

7-3. Plastic product

No.	Parts list	note	QTY
2	Speak		2
4	Speaker cover		2
8	B18.6.7M – M4 x 0.7 x 10 Type I Cross Recessed PHMS -- 10N		28

